

PROSKIRTING INS

ANODIZED SILVER ALUMINIUM

PROSKIRTING INS is the new innovative skirting designed with an integrated system for plasterboard walls, and devised to create a recessed skirting for a modern and minimalist design in line with the latest trends.

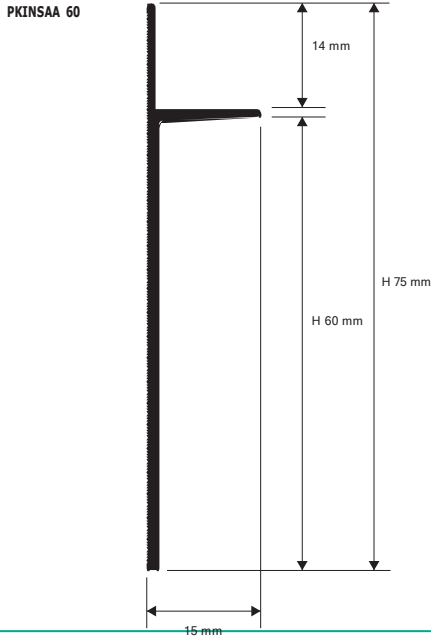

ANODIZED SILVER ALUMINIUM thermo packed bar length 2 lm - pack. 30 Pcs - 60 lm

Article	H x L mm			
PKINSAA 60	60 X 15			
PKINSAA 60F	60 X 15			*

ON DEMAND MAY BE REALISED IN OTHER FINISHES OF THE COLOUR CHART. CONTACT OUR CUSTOMER SERVICE FOR MINIMUM QUANTITY (MINIMUM QUANTITY ORDER OF 500 LM), TIMING AND PRICE.

EXAMPLES AND INSTRUCTIONS FOR LAYING METHODS

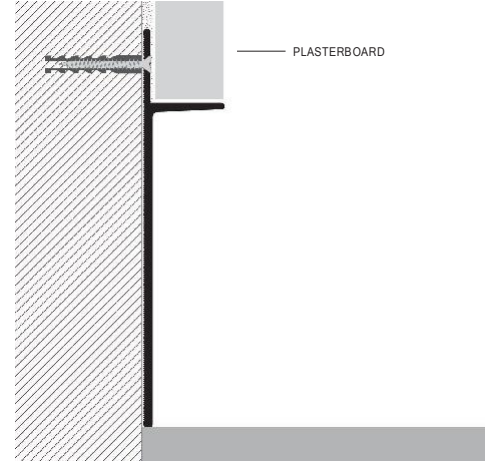

1. Fix "PROSKIRTING INS" using screws (concealed part) and glue/silicone (exposed side), before laying the plasterboard, calculating all the heights and distance. 2. Lay the plasterboard aligning the lower part flush to the "PROSKIRTING INS". 3. Plaster and carry out the surface finishing on the plasterboard.

USE PROBAND FIX FOR FIXING THE PROFILE TO THE WALL



(PAGE 324)

COLOURS

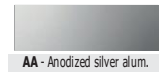

AA - Anodized silver alum.

PROSKIRTING INS 202060

ANODIZED SILVER, VARNISHED ALUMINIUM

PROSKIRTING INS 202060 is an anodized or painted aluminium skirting board, composed of a 60 mm vertical part, equipped with horizontal stripes to facilitate bonding and a horizontal protruding 20 mm part on which to lay the plasterboard. The cavity that is created can also be used for laying any skirting flush with the wall or left exposed. PROSKIRTING INS 202060 aluminium is suitable as baseboards in any interior environment.

PKINS..

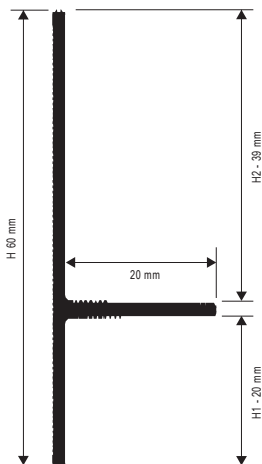

ANODIZED SILVER ALUMINIUM thermo packed bar length 2 lm - pack. 20 Pcs - 40 lm

Article	H mm	H1 mm	H2 mm		
PKINSAA 202060	60	20	39		

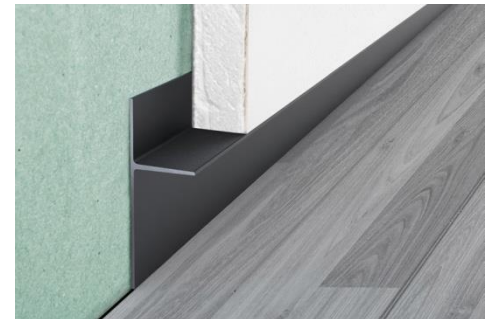

VARNISHED MATT BLACK ALUMINIUM thermo packed 2 lm20 Pcs - 40 lm

Article	H mm	H1 mm	H2 mm		
PKINS 202060-110	60	20	39		*

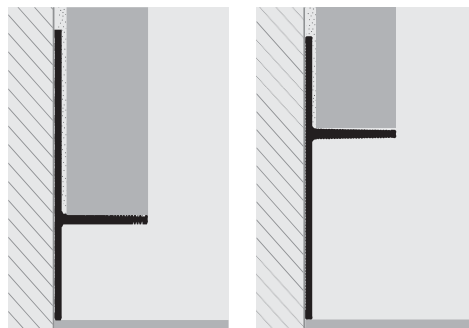

EXAMPLES AND INSTRUCTIONS FOR LAYING METHODS

1. Fix to the wall with adhesive "PROSKIRTING INS 202060" 2. Lay the plasterboard taking care to align it below with the horizontal section 3. Apply the desired finish 4. Immediately remove product residues from the profile surface.

COLOURS



AA

110